

Jefferson Pointe Outparcel | Ft. Wayne, IN

Fully Leased | First Watch & Xfinity

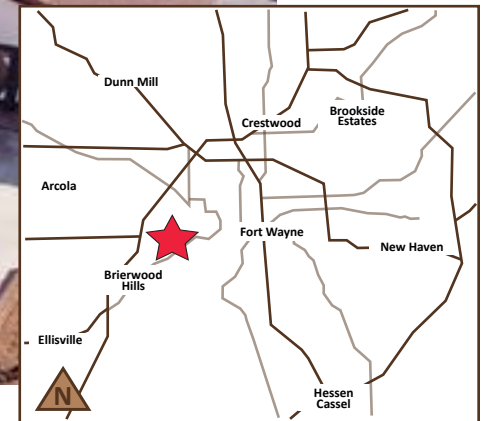

Property Highlights:

- Fully Leased Shopping Center with First Watch and Xfinity
- Excellent visibility to the heavily trafficked stoplight intersection of Illinois & Apple Glen Blvd. (41,767 combined cars per day)
- Just east of I-69 (71,093 cars per day)
- Outparcel to Jefferson Pointe lifestyle center with newly announced Trader Joe's.

DEMOGRAPHICS	1 mile	3 mile	5 mile
Population	3,850	45,618	141,550
Households	1,990	20,151	59,282
Average HH Incomes	\$59,734	\$61,671	\$61,087
Employees	8,093	39,773	127,205

FOR MORE INFORMATION
PLEASE CONTACT:

Shannon Hunt

P: 317-472-1800

E: Shannon@VeritasRealty.com

Seth Biggerstaff

P: 317-472-1800

E: Seth@VeritasRealty.com

VR VERITAS
REALTY

A MEMBER OF
CHAINLINKS
RETAIL ADVISORS

Jefferson Point Outparcel | Ft. Wayne, IN 3,900 SF Former Restaurant | Endcap

4541 Illinois Rd., Fort Wayne, IN 46804



FOR MORE INFORMATION
PLEASE CONTACT:

Shannon Hunt
P: 317-472-1800

E: Shannon@VeritasRealty.com

Seth Biggerstaff
P: 317-472-1800

E: Seth@VeritasRealty.com

VR VERITAS
REALTY

A MEMBER OF
CHAINLINKS
RETAIL ADVISORS

Jefferson Pointe Outparcel | Ft. Wayne, IN 3,900 SF Former Restaurant | Endcap

4541 Illinois Rd., Fort Wayne, IN 46804

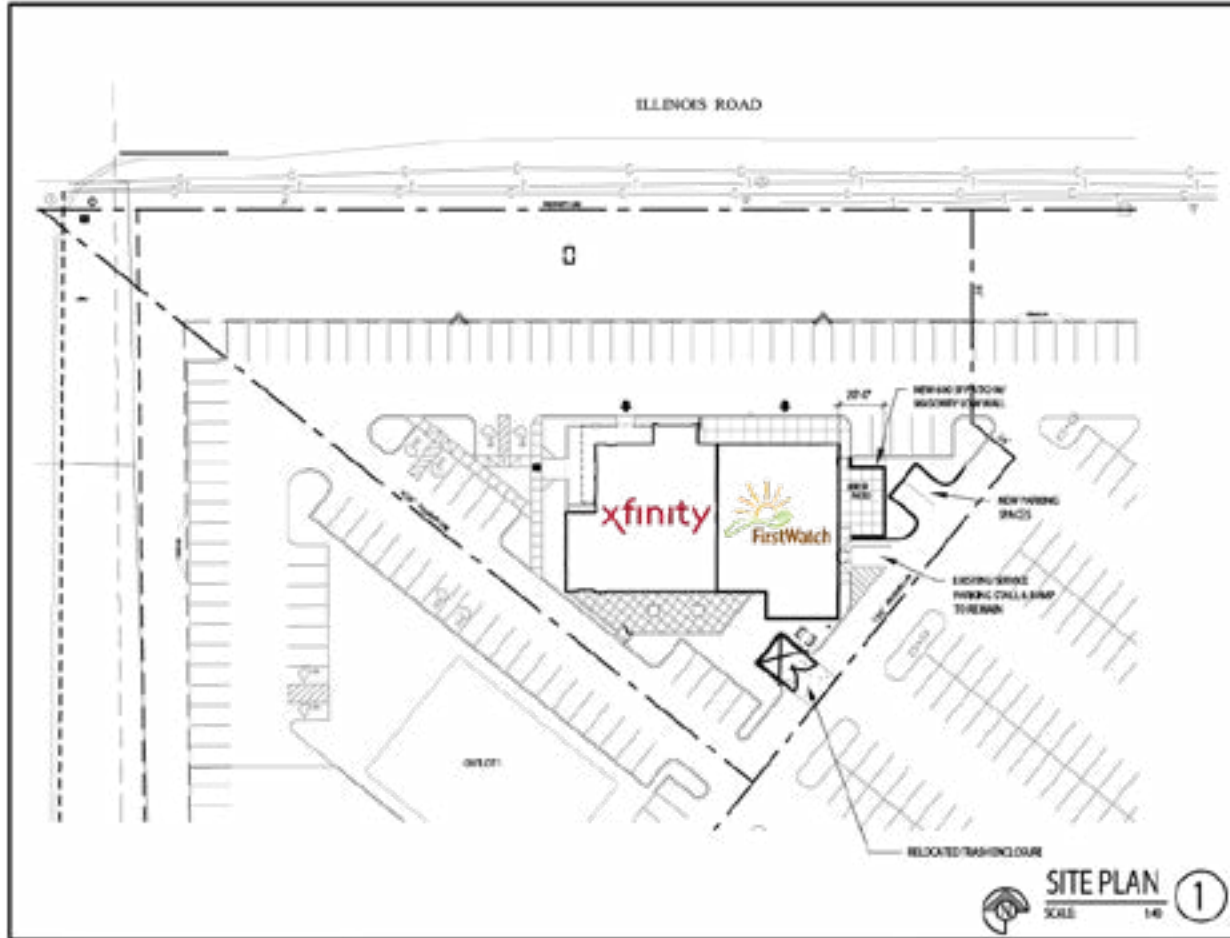

hckloverarchitect
3833 HUNTERS LANE, SUITE 400, FORT WAYNE, IN 46804
PH: 317.438.8811 • FAX: 317.438.1125 • www.hckloverarchitect.com

project title
LOO
FT WAYNE, ID
SPACE REDEVELOP
project location
FORT WAYNE, ID

project number
2045000
drawing issuance
03/18/2020
drawing revision
professional seal

ARCHITECTURAL
SITE PLAN

A100

SITE PLAN ①
SCALE: 1/8" = 1'-0"

FOR MORE INFORMATION
PLEASE CONTACT:

Shannon Hunt

P: 317-472-1800

E: Shannon@VeritasRealty.com

Seth Biggerstaff

P: 317-472-1800

E: Seth@VeritasRealty.com



Jefferson Pointe Outparcel | Ft. Wayne, IN 3,900 SF Former Restaurant | Endcap

4541 Illinois Rd., Fort Wayne, IN 46804



FOR MORE INFORMATION
PLEASE CONTACT:

Shannon Hunt

P: 317-472-1800

E: Shannon@VeritasRealty.com

Seth Biggerstaff

P: 317-472-1800

E: Seth@VeritasRealty.com

VR VERITAS
REALTY

A MEMBER OF
CHAINLINKS
RETAIL ADVISORS